

**SREE CHITRA TIRUNAL INSTITUTE FOR MEDICAL SCIENCES & TECHNOLOGY,
THIRUVANANTHAPURAM**

(An Institute of National Importance under Government of India)

PHONE: (91) 0471 2524 445/145/245; FAX: 0471 2550728 Email:purchase@sctimst.ac.in

CORRIGENDUM TO TENDER NO: SCT/P/2015-16/CAN-EQ/FUR/SAY

The revised tender documents for CANTEEN-KITCHEN EQUIPMENTS/FURNITURE in respect of Tender no: SCT/P/2015-16/CAN-EQ/FUR/SAY is notified herewith.

15/04/2016

For more details pl visit: www.sctimst.ac.in

**Sd/-
DIRECTOR**

(Sr.P&SO)

(DMS)

(MS)

(DIRECTOR)

**SREE CHITRA TIRUNAL INSTITUTE FOR MEDICAL SCIENCES &
TECHNOLOGY, TRIVANDRUM-695011, KERALA, INDIA**

(An Institute of National Importance under the Government of India)

Phone:0471-2524445/2524145/2524225/,Fax:0471-2550728

Email:purchase@sctimst.ac.in

SHORT TENDER

Sealed Tenders in two bid system are invited for the supply of the following stores from Foreign Manufacturers/their accredited Indian Agents/Indian Manufacturers/ their Distributors:

SL.No	Particulars	Tender No.
1.	CANTEEN-KITCHEN EQUIPMENTS/FURNITURE	SCT/P/2015-16/CAN-EQ/FUR/SAY

The tenders should be superscribed tender for (specify name of the item) and addressed to the Director, Sree Chitra Tirunal Institute for Medical Sciences & Technology, Medical College P.O., Trivandrum -11. Late tenders will not be accepted. The tenders will be opened at 03.00 pm on 05/05/2016 in the presence of such of the tenderers or their authorized representatives who may be present at that time.

Intending tenderers may, on application to the Sr. Purchase & Stores Officer obtain the requisite tender forms on which tenders should be submitted. Application for tender form should be accompanied by a Cash/DD remittance of Rs.500/- plus VAT @ 5% which is the price fixed for the form/set of forms and which is not refundable under any circumstances. Tender forms are not transferable. Sale of tender forms will be Closed at 04.00pm on 30/04/2016. Cheques postage stamps etc will not be accepted towards cost of forms, nor will the forms be sent by V.P.P. Tenders will be received upto 1.00 PM on 05/05/2016. All tenders should be accompanied by EMD for 5% of the FOB value of the total quoted items (rates multiplied by quantity).The exchange rates shall be at Bill Selling rates prevailing on the date of opening of tenders. The EMD can be by way of Demand Draft favouring Director, SCTIMST or Bank guarantee (format enclosed). The EMD should be enclosed with Commercial bid only, not with the Technical bid. The EMD and Tender cost can be waived based on relevant certificates for the tendered items on production of documents such as DGS&D/NSIC Registration Certificate etc for the specific category of item and remain valid for the period required for EMD.

In addition to the above, the tender notices are posted in the website of the Institute. The tender documents are also available in the website www.sctimst.ac.in for downloading from the computer by the prospective tenderers. The cost of tender documents can be paid by such tenderers in the form of demand draft drawn in favour of the Director of the Institute while submitting their offers with the bid / tender documents. The cost of such downloaded documents should be kept along with the Technical bid.

Duplicate tender forms, if required, will be issued at Rs.100/- per copy. VAT @ 5% will be charged extra on both the sales. The Director of the Institute reserves the right to accept or reject all or any tender at his sole discretion without assigning any reason.

(Sd/)
DIRECTOR

TERMS & CONDITIONS

In addition to the conditions mentioned in the tender notice and attached schedule the following will also form part and parcel of the tender documents.

1. The prices quoted should be FOB in foreign currency by Ocean Freight/Air Freight or FOR Trivandrum for delivery at our Institute in INR, if the tenderer prefers to quote in INR. (This clause is applicable as per the mode of quote).

2(a) The tenderer should clearly state whether he/they are manufacturer, accredited agents, or sole representative (indicating the name of Principal) on the top of the Bid.

b)The Foreign Manufacturers, whether they participate in the tender directly or through their accredited agents should furnish an undertaking that they will directly or through their agents take the responsibility of maintenance of the equipment supplied and installed for a period of 10 years from the date of successful installation and commissioning of the equipment.

3. Agency Commission if any to be deducted from Ex-works/ FOB/CIF value and is payable to Indian Agents should be indicated separately for payment in Indian Rupees, if the quotation is in foreign exchange.

4. Customs Duty, Excise Levies etc. if payable should be mentioned in the quotation separately. Rates quoted should be firm for acceptance by us within a period of 6 (six) months (180 days) from the date of opening.

5. (a) Detailed Technical bid and Commercial bid should be furnished in separate covers. The items to be included in both the bids are given at annexure-2. Technical bid will be opened first and after evaluation, the commercial bid will be opened on prior intimation to qualified tenderers. Both the technical bid and commercial bid should be in sealed covers and can be enclosed in a larger sealed cover. (b) Negotiation may be conducted with the lowest qualified tenderer. The firm should quote for all items. The order will be given to a single agency to install the equipments as per the layout attached. Price should be quoted after carefully studying the specifications and design layout of kitchen. If necessary the firm representative can visit and site for inspection (Contact- Construction Engineer-0471-2524580)

6. All offers should be accompanied with:-

- a) Detailed specifications of the items offered.
- b) Technical diagrams, illustrations etc.
- c) The delivery schedule of item should be specified in the offer.

- d) Other documents detailed as per schedule.
7. The successful tenderer will have to arrange for remitting security deposit and execute an agreement as called upon by the institute. This may be in the form of a Performance Bank Guarantee/Demand draft for 10% of total assignment (purchase value) from commercial bank which should be valid for a period of 60 days beyond the completion of all contractual obligations of the supplier including warranty.
8. Price list of essential spares shall be provided along with the quotation, it should be frozen for a minimum period of 3 years after warranty period.
9. a) Warranty should be for a minimum period of 3 years from the date of installation and commissioning of system.
- b) After warranty if the institute desires to enter into AMC, the maximum of Annual Maintenance Charges, for comprehensive service is 5% and for AMC Labour service is 2.5% of Ex-Works / FOB/CIF value as the case may be. Both the AMC charges will be allowed 5% increase annually to the maximum. AMC exchange rate calculation- FOB at the time of RV.
10. Mode of payment should be indicated. The payment modes available are following:
- (1) Irrevocable Letter of Credit
 - (2) Sight draft against original documents through our banker's (STATE BANK OF TRAVANCORE, MEDICAL COLLEGE BRANCH, THIRUVANANTHAPURAM-695 011, PH: 0471-2443271, Email: mctrivandrum@sbt.co.in)
 - (3) Wire Transfer/Telephonic Transfer or Demand draft will be applicable only after the receipt of the item.
 - (4) By cheque within 30 days of satisfactory installation and commissioning.
11. All bank charges outside India are to the beneficiary's account.
12. Tenders not accompanied with sufficient EMD (5% FOB value of the quoted products/ rates multiplied by quantity) shall automatically stand rejected. The exchange rates shall be at the Bill selling rates prevailing on the date of opening of tenders. The EMD should have a validity of 180 days from the date of opening. The successful tenderer has to extend the validity of the EMD if required by the Institute. The EMD can be waived based on relevant certificates for the tendered items on production of documents such as DGS& D, NSIC Registration Certificate for the specific category of item and remain valid for the period required for EMD.
13. REMOTE SERVICE ACCESS if required has to be provided at the supplier's cost.

- 14. The tenderer submitting his tender would be deemed to have considered and accepted all the terms and conditions.**
- 15. The quantity shown in the Schedule may increase or decrease to any extent depending upon the actual requirement.**
- 16. The tenderer shall submit the pre-requisite information like Civil works/ Electrical works, Air Conditioning etc. within 2 weeks from the date of receipt of order or establishment of letter of credit as the case may be.**
- 17. In the case of placement of Purchase Order, the vendor (the tenderer whose tender is accepted) shall have to confirm the purchase order within 7 days from the date of receipt of purchase order otherwise it will be deemed that the purchase order is accepted by vendor. However, if the supplier notices any mistake in the contents of the order, he must bring the same to the notice of the Institute and seek clarifications. Supplier will have to bear the responsibility for failure to take this action.**
- 18. All disputes arising out of this purchase contract, the legal jurisdiction will be Trivandrum, Kerala, India.**

19. Penalty clause:

(I) Delay Delivery: If the delivery is not effected on due date the Director, SCTIMST will have the right to impose penalty at 0.5% per week subject to a maximum of 5% of order value.

(II) Performance (during warranty period and AMC period): (a) Uptime means 95% of total days in a year excluding Sundays and Institute Holidays. (b) Down time means any shortage in achieving the uptime of 95% (c) Down time penalty will be levied at the rates shown below;

a). Equipment for which EX-works/FOB/CIF value is up to Rs. 10 Lakhs penalty is 0.5% per day of such value of the equipment.

b). Equipment for which Ex-Works/ FOB/ CIF value is above Rs.10 Lakhs but up to Rs.50 lakhs penalty at 0.2% per day of the cost of the equipment subject to a minimum of Rs.5,000/- per day.

c). Equipment for which Ex- Works / FOB/ CIF value exceeds Rs.50 Lakhs penalty is at 0.1% per day of the cost of the equipment subject to a minimum of Rs.10,000/- per day and maximum of Rs. 50,000/- (Rupees Fifty Thousand Only) per day.

d) Penalty will be leviable for each (a single) equipment.

e) Even if the total days of down time in a year is below 5%, if the equipment is Down for more than 5 working days continuously, excluding reporting and repairing days and also holidays, on any occasion, penalty at the above rate will be levied for such down time exceeding 5 days. For this purpose repairing day is a single day on which the machine is reported as repaired and working means fully working.

20. **Recovery Clause:** All losses liquidated or otherwise due to the violation of terms and conditions of the purchase order or defective documentation will be to the supplier/agent's account.

21. **Installation & Commissioning:** Supply should undertake, commissioning and demonstration at our facility free of cost.

22. Training should be provided free of cost.

23. Form No.16,DSIR Certificate if needed for clearing the item shall be mentioned in the Technical Bid.

24. In the case of import items purchase following documents will be required for negotiation of documents.

- (1) Airway bill
- (2) Certificate of Origin issued by or certified by local chamber of commerce.
- (3) Packing list
- (4) Invoice

25. If the items involves softwares, companies should avail software license in the name of Director, SCTIMST and the paper license/email license to be transferred to the concerned HOD and should be mentioned in the invoice.

26. 2 Nos. of technical/service manual in original will also be provided along with the equipment at free of cost.

27. All correspondence after tender submission will be by e-mail only and the company should provide their valid email id and should keep it updated.

28. Tax as per Govt of India rules.

Sd/-

DIRECTOR

ANNEXURE-1

SPECIFICATION FOR CANTEEN-KITCHEN EQUIPMENTS/FURNITURE

NOTE-ALL STEEL PLATES USED WILL BE OF GRADE 304 STAINLESS STEEL AND 16SWG THICK/18SWG/20SWG AS SPECIFIED. ALL STEEL PIPES RECTANGULAR/CIRCULAR SHAPE WILL BE OF S.S 304 GRADE OF THICKNESS 2MM.

1) FMTABL0150-PICK UP TABLE WITH ONE UNDER SHELF WITH THREE SIDE COVERING AND TRAY SLIDER- QUANTITY- 2NOS

TABLE TOP MADE BY 16SWG S.S. SHEET 304 GRADE SHEET AND BOTTOM UNDERSHELF MADE BY 18 SWG S.S SHEET 304 GRADE 3 SIDE COVERING 20SWG BY S.S. SHEET 304 GRADE AND TRAY SLIDE 4 NOS BETWEEN TOP AND BOTTOM OF THE TABLE .LEGS AND NECESSARY SUPPORTS SHOULD ALSO MADE BY S.S 304 QUALITY PIPES ONLY, LEGS ARE 1 1/2" DIA,16SWG THICK)(NOT POLISHED PIPE. (L-1800, W- 625,H- 850 MM)

2) EQCOUN0115-BAIN MARIE PICK UP COUNTER WITH ONE UNDER SHELF, THREE SIDE COVERING AND TRAY SLIDER(4 NOS 1/1, 4 NOS 1/2)- QUANTITY-1 NO

TOP SHEET 16 SWG S.S 304 LEGS AND SUPPORT 1 1/2 "X1 1/2" 16SWG S.S SQUARE POLISHED. HOT WATER TANK MADE AND 3 SIDE COVERING BY 20 SWG , S.S 304 QUALITY AND TRAY SLIDED 4 NOS BOTTOM 1 UNDER SHELF AUTO ELECTRIC HEATING SYSTEM .(L-2400,W-625,H-850 MM)

3) FMTABL0154-WORK TABLE WITH ONE UNDER SHELF REAR FLASH- QUANTITY-3 NOS

TABLE TOP MADE BY 16 SWG S.S SHEET 304 GRADE AND TOP 3 SIDES 6" SPLASH AND BOTTOM UNDER SHELF MADE BY 18 SWG S.S SHEET 304 GRADE. LEGS AND NECESSARY SUPPORTS SHOULD ALSO MADE BY S.S 304 GRADE QUALITY 1 1/2" DIA, 16SWG THICK PIPES)(NOT POLISHED PIPE.(L-1800,W-600,H-850+150MM)

4) FMTABL0153-WORK TABLE WITH ONE UNDER SHELF REAR SPLASH- QUANTITY-1 NO

TABLE TOP MADE BY 16 SWG S.S SHEET 304 GRADE AND TOP 3 SIDES 6" SPLASH AND BOTTOM UNDER SHELF MADE BY 18 SWG S.S SHEET 304 GRADE .LEGS AND NECESSARY SUPPORTS SHOULD ALSO MADE BY S.S 304 GRADE QUALITY PIPES,LEGS ARE 1 1/2" DIA, 16SWG THICK)(NOT POLISHED PIPE.(L-1500,W-600,H-850+150MM)

5) FMTABL0155-GRANITE TOP TABLE WITH ONE UNDER SHELF REAR SPLASH-QUANTITY-1 NO

TABLE FRAME BY 16 SWG S.S 304 GRADE RECTANGULAR 1 1/2"X1" PIPES AND TOP 3 SIDES SPLASH 6" . LEGS 1 1/2" X1 1/2" S.S RECTANGULAR PIPE WITH BOTTOM ONE UNDER SHELF BY 18 SWG S.S SHEET 304 GRADE PIPES ONLY)((NOT POLISHED PIPE. THE TOP IS FITTED WITH STUD WELDED BOLTS WITH THE FRAME FOR STURDY AND STRONGER GRIP(L-1500,W-600,H-850+150MM)

6) EQHOTP0114-HOT PLATE WITH BOTTOM CROSS SUPPORTS REAR SPLASH-QUANTITY-2 NOS

MADE OUT OF 12MM THICK M.S PLATE ON TOP WITH MOUNTED M.S ANGLE FRAME DULY RUST PROOF PAINTED, WITH 3 SIDE S.S 304 GRADE 18SWG SHEET 6" HEIGHT SPLASH BACK IN TOP . VERTICAL LEGS OF SS304 GRADE 1 1/2" DIA 16SWG THICK PIPES. SUPPLY OF 'V' TYPE GAS BRASS BURNER , NC VALVE AND COPPER PIG TAILS WITH PLATE ALSO COVERING IN S.S

SHEET, GLASS WOOL PACKING PAD FOR HEAT PROOFING PURPOSE.(L-1500, W-750, H-850+150MM)

7) FMTABL0156-SPREADER TABLE WITH ONE UNDER SHELF REAR SPLASH-1 NO

TABLE TOP MADE BY 16 SWG S.S SHEET 304 GRADE AND TOP 3 SIDES 6" SPLASH AND BOTTOM UNDER SHELF MADE BY 18 SWG S.S SHEET 304 GRADE .LEGS AND NECESSARY SUPPORTS SHOULD ALSO MADE BY S.S 304 GRADE 1 1/2"X1" 16SWG THICK QUALITY PIPES) (NOT POLISHED PIPE.(L-400,W-750,H-850+150MM)

8) FMTRLY0152-MASALA TROLLEY-QUANTITY- 1 NO

MADE OUT OF TOP 16SWG S.S 304 GRADE, CONTAINER FULLY ROUND VESSEL WHICH CONTAINED 1KG MASALA EACH ,(ROUND CYLINDRICAL BOX VESSEL 8 NOS) WITH LID PROVIDED ,FULLY S.S POLISHED 1 1/2" 16SWG PIPE LEGS WITH ROLLER WHEELS AT BOTTOM FOR MOVEMENT .(L-850,W- 450 ,H- 850MM)

9) EQMIXR0112- DOUGH MACHINE WITH CAPACITY 20 KG-QUANTITY-1 NO

BODY COMPLETELY CONSTRUCTED OF HEAVY DUTY CAST IRON WITH GEAR BOX MOUNTED ON THE TOP THE MIXING BOWL OF S.S-304 SHEET 14SWG WITH SS 304 GRADE ARM TO MIX THE DOUGH AND IS OPERATED ELECTRICALLY WITH HEAVY DUTY MOTOR OF 1HP. BRAKE SYSTEM TO CHANGE THE SPEED TO THE VESSEL , SOUNDLESS WORKING ,DRUM AND ARMS ARE FULLY SS 304 GRADE SUITABLE FOR 20KG DOUGH PREPARATION. MOTOR SHALL BE S1 TYPE OF IS:325 STANDARD (LATEST VERSION) AND KIRLOSKAR/NGEF/SEIMENS/ABB/GEC/CROMPT ON GREAVES MAKE.

10) FMRACK0124- STORAGE RACK (4 TIER)-QUANTITY-2 NOS

TRAY MADE BY 16 SWG S.S SHEET 304 GRADE ,LEGS AND SUPPORTS FULLY 1 1/2"X1 1/2" S.S 16SWG THICK POLISED PIPE.TRAYS ARE MOUNTED ON THE LEGS IN AN EQUAL PARTITION WITH ROLLER WHEELS AT BOTTOM FOR MOVEMENT.(L-1200,W- 550,H 1500MM)

11) FMTRLY0153-VEGETABLE CRATE RACK TROLLEY WITH 9NO CRATES-QUANTITY-1 NO

MADE WITH 1 1/2"X1" 16 SWG S.S PIPE 304 GRADE WITH CROSS SUPPORT 1"X1" SQUARE PIPES 16SWG PIPES WITH ROLLER WHEELS AT BOTTOM FOR MOVEMENT.(L-465,W-600,H- 1800MM)

12) FMTABL0151-WORK TABLE WITH BOTTOM CROSS SUPPORTS REAR SPLASH-QUANTITY-1 NO

TABLE TOP MADE BY 16 SWG S.S SHEET 304 GRADE AND TOP 3 SIDES 6" SPLASH AND BOTTOM CROSS SUPPORT LEGS 1 1/2"X1 1/2" MADE S.S 304 GRADE 16 SWG THICK QUALITY PIPES(NOT POLISHED PIPES).(L-1400, W-600, H-850+150MM)

13) FMTABL0152-WORK TABLE WITH SINK BOTTOM CROSS SUPPORTS REAR SPLASH-4 NOS

TABLE TOP MADE BY 16 SWG S.S SHEET 304 GRADE AND TOP 3 SIDES 6" SPLASH SINK 16"X16"X10" SIZE MADE BY 18 SWG S.S SHEET 304 GRADE .ALONG WITH TOP BOTTOM CROSS SUPPORT LEGS 1 1/2" MADE BY S.S 304 GRADE 1 1/2" DIA 16SWG PIPE (NOT POLISHED PIPE). (L-1400, W- 600, H-850+150MM)

14) EQGRIN0113-WET GRINDER 10LITRE -QUANTITY-1 NO

MADE OUT OF S.S 304GRADE BODY AND S.S DRUM AND QUALITY STONE WITH 3 PHASE MOTOR COMMERCIAL TYPE WITH COCONUT SCRAPPER ETC.

15) EQGRIN0114-WET GRINDER 15LITRE -QUANTITY-1 NO

MADE OUT OF S.S BODY 304 GRADE BODY AND S.S DRUM AND QUALITY STONE WITH 3 PHASE MOTOR COMMERCIAL TYPE WITH COCONUT SCRAPER ETC.

16) FMRACK0125-POT RACK 3 TIER-QUANTITY-2 NOS

LEGS FULLY MADE BY 1 1/2"X 1 1/2" AND S.S 304 GRADE POLISHED PIPE 16SWG FRAME 11/4"X11/4" 16SWG INNER CROSS 3/4" ROUND S.S 304 GRADE POLISHED 16SWG FRAMES ARE MOUNTED ON LEGS IN AN EQUAL PARTITION.(L-1500,W-600.H- 1800MM)

17) FMTABL0157-DISH LANDING TABLE WITH CHUTE REAR SPLASH BOTTOM CROSS SUPPORTS-QUANTITY-1 NO

TOP MADE BY 14 SWG S.S 304 GRADE WITH CHUTE .LEGS 1 1/2"X1 1/2" 16SWG AND SUPPORTS BOTTOM CROSS SUPPORTS FULLY S.S 304 GRADE.(L-1500, W-750, H-850+150MM)

18) EQWSHS0112-THREE SINK UNIT WITH BOTTOM CROSS SUPPORTS REAR SPLASH-QUANTITY-1 NO

MADE OUT OF 16 SWG ,S.S SHEET 304 QUALITY AND FABRICATED WITH 3 SINKS OF EQUAL SIZES FITTED AND IT IS MOUNTED ON S.S PIPE LEGS OF SIZE 1 1/2"X1 1/2" SQUARE 16SWG 304 GRADE . (L-1800, W-750, H-850+150MM)

19) FMTABL0158-DRAIN TABLE WITH BOTTOM CROSS SUPPORTS REAR SPLASH-QUANTITY-1 NO

TABLE TOP MADE BY 16 SWG S.S SHEET 304 GRADE AND TOP 3 SIDES 6" SPLASH AND BOTTOM CROSS SUPPORT LEGS 1 1/2"X1 1/2" MADE S.S 304 GRADE 16SWG QUALITY PIPES(NOT POLISHED PIPES).(L-1000, W-750, H-850+150MM)

20) FMRACK0126-PLATE STORAGE RACK(4 TIER)-QUANTITY-2 NOS

MADE OUT OF LEGS 1 1/2" X1 1/2" S.S POLISHED 16SWG SQUARE PIPE ,1 1/4"X11/4" SS POLISHED PIPE ,LEGS, PLATE STANDING ROD WELDED IN THE FRAME MADE OUT OF 6MM S.S POLISHED ROD WITH WATER COLLECTING TRAY . 4" NYLON WHEEL ALSO TO BE PROVIDED FOR MOVEMENT.(L-1500, W-500, H-1500MM)

21) EQGRIN0115- WASTE DIGESTER-QUANTITY-1 NO

22) EQBLOW0114-EXHAUST HOOD- QUANTITY-1 NO

ENTIRE EXHAUST IS MADE OF 20SWG SS304 GRADE SHEET WITH SS 304 GRADE BAFFLE FILTERS. PROVISION OF CLOSING AND OPENING OF BAFFLE FILTERS FOR CONTROLLING HOT AIR FLOW. FILTERS SHOULD BE EARLY REMOVABLE AND WASHABLE, FILTERS AND FRAME WORK SHALL BE PROVIDED WITH WEEP HOLES FOR DRAINING OF OIL. HOOD SHOULD BE FITTED WITH GREASE COLLECTION TRAY. THE HOOD SHALL BE CONNECTED TO EXHAUST DUCT WITH APPROPRIATE FRAME WORK/METAL FASTNERS. SHAPE OF THE HOOD SHALL BE RECTANGULE/SQUARE AT BOTTOM TAPERED TO RECTANGULAR/SQUARE AT THE JUNCTION WITH DUCT. BOTTOM POINT OF HOOD FIXED AT 1950/2000MM FROM FINISHED FLOOR LEVEL.

(A) L-3000 W-1000,H-600- QUANTITY-1 NO

(B) L-2000 W-1000,H-600- QUANTITY-1 NO

(C) L-1000 W-1000,H-600- QUANTITY-1 NO

(D) L-4000 W-1000,H-600- QUANTITY-1 NO

(E) L-1500 W-1000,H-600- QUANTITY-1 NO

23) EQBLOW0115-GI DUCTING

22 SWG GI SHEET OF TATA/JINDAL SHEET) EXHAUST (60 SQM APPROXIMATE) WITH ALL CONNECTED ACCESSORIES FOR FITTMENT OF THE DUCT ON THE CEILING AND WITH HOOD AS PER SITE LAY OUT/SITE CONDITIONS. PLAT FORM FOR FIXING BLOWER, SMOOTH BENDS, BENTS TO BE FIXED WITH MS ANGLE AND MS SUSPENDERS FIXED ON TO THE CEILING/WALL WITH ALL ALLIED FIXING MATERIALS. TOTAL AREA OF DUCT 60SQM (LENGTH 38MTR). THE JOINTING FLANGES TO BE MADE WITH 35X35X3 MM. MS ANGLE. 8MM GI RODS AND PAINTED 35MMX35MMX3MM MS ANGLE AT AN INTERVAL OF 2MTR SHALL BE USED TO SUSPENDED THE DUCTING ON TO CEILING/WALL. DUCT JOINTS TO BE BOLTED TOGETHER WITH GASKET FOR AIR TIGHT SEAL.

(A) L-6000 W-400 H-200-QUANTITY-1 NO

(B) L-5000 W-300 H-200-QUANTITY-1 NO

(C) L-27000 W-500 H-450-QUANTITY-1 NO

24) EQBLOW0116-EXHAUST BLOWER-QUANTITY-1 NO

CENTRIFUGAL BACKWARD INCLINED SISW BLOWER WITH SUITABLE HIGH STATIC PRESSURE TO CREATE THE REQUIRED INTAKE VELOCITIES AND OVERCOME THE PRESSURE LOSS AT THE INLET OF FILTERS AND DUCTS. TYPE:SISW CENTRIFUGAL BLOWER. (MOTOR OUTSIDE THE EFFLUENT AIR STREAM) IMPELLER: BACKWARD INCLINED, NON OVER LOADING TYPE. (SMALLER MOTOR), DRIVE: MOUNTED DIRECTLY ON MOTOR SHAFT. (SLIP LOSSES AND LESSER MAINTANANCE) DYNAMICALLY BALANCED TO PROVIDE A VIBRATION FREE OPERATION. CONSTRUCTION:-CASING: IN 3MM THICK MS SHEET WITH SUITABLE ANGLE REINFORCEMENT. IMPELLER: IN 5MM THICK MS SHEET. FINISH: WITH TWO COATS OF RED OXIDE PRIMER AND TOP COAT EXTERIOR DURABLE PAINT. FAN SPEED NOT EXCEEDING 1000RPM. CONTROL PANEL: WALL MOUNTED INCORPORATED WITH SUITABLE STARTER OF MAKE SIEMENS/L&T WITH SINGLE PHASE PREVENTION. 9400 CFM/960 RPM 7.5 HP 3PHASE ,415 VOLT,50HZ WITH ALL REQUIRED SWITCH GEARS WITH PROTECTION DEVICES CONNECTED AND WIRING .SUITABLY FITTED WITH ALL FITMENTS TO BE INTERGRATED WITH DUCTING SYSTEM.

25) UTSTOV0111-BULK COOKING RANGE -QUANTITY 2 NOS

S.S 304 GRADE COVERING , MADE OUT OF M.S ANGLE FRAME DULY RUST PROOF PAINTED AND S.S LEGS 1 1/2" DIA FABRICATED WITH TOP AND 4 SIDE COVERING IN S.S 304 GRADE 18SWG THICK SHEET IN TOP FITTED WITH ROUND TYPE CAST IRON PAN SUPPORT . GAS BRASS BURNER OF T-35 TYPE , NC VALVES ,HEAVY COPPER PIG TAILS WITH WASTE COLLECTING TRAY.(L-750,W- 750,H- 500MM)

26) UTSTOV0112-TWO BURNER COOKING RANGE WITH BOTTOM CROSS SUPPORTS-QUANTITY 1 NO

MADE OUT OF TOP 4 SIDE S.S 304 QUALITY , WITH TOP 3 SIDE 6" SPLASH 18 SWG 4 SIDE 20 SWG S.S COVERING , LEGS 1 1/2"X1 1/2" 16SWG S.S SQUARE POLISHED PIPE LEGS , M.S ANGLE FRAME DULY RUST PROOF PAINTED AND S.S LEGS FABRICATED WITH 1 1/2"X1 1/2" 16SWG., WITH TOP FITTED ROUND TYPE CAST IRON PAN SUPPORT. GAS BRASS BURNER 1 X T-22 TYPE AND 1XT-35 TYPE, HEAVY NC VALVES, HEAVY COPPER PIG TAILS.(L-1200, W-750, H-850+150MM)

27)UTSTOV0113-THREE IN ONE BULK COOKING RANGE-QUANTITY-1 NO

S.S 304 GRADE COVERING , MADE OUT OF M.S ANGLE FRAME DULY RUST PROOF PAINTED AND S.S 304 GRADE LEGS 1 1/2" DIA 16SWG FABRICATED WITH TOP AND 4 SIDE COVERING IN S.S 304 GRADE 18SWG SHEET IN TOP FITTED WITH ROUND TYPE CAST IRON PAN SUPPORT . GAS BRASS BURNER 2XT-22 TYPE AND 1X T-35 TYPE , NC VALVES ,HEAVY COPPER PIG TAILS WITH WASTE COLLECTING TRAY.(L-900,W- 900,H 500MM)

28) GABINS0112-ONION/POTATO BIN-2 NOS

LEGS AND SUPPORTS BY 1 1/2"X1 1/2" 304GRADE 16SWG PIPE .COVERING FULLY BY 1"X1" S.S MESH .BOTTOM SIDE 1 MESH DOOR .TOP SIDE 1 OPEN DOOR.(L-500,W-500,H- 700MM)

29) UTBORD0111-NYLON CHOPPING BOARD WITH STAND- QUANTITY-1 NO

2" THICK SIZE ,6" SPLASH WITH HEAVY SUPPORT. STAND MADE WITH SS 304GRADE 16SWG THICK SHEET AND LEGS 1"X1" 16SWG RECTAMGULAR PIPE.(L-500, W-500, H-850+150MM)

30) UTGRIL0111-POT WASH GRIL-QUANTITY-2 NOS

SIDES AREA PROVIDE 16 SWG S.S 304 GRADE 16SWG THICK SQUARE TUBE 25X25MM PIPES 304 GRADE AND INNER CROSS PROVIDE 20MM DIA 16 SWG S.S PIPES WITH 12MM GAP(L-1000,W- 800,H- 150MM)

31) UTCOKR0112-IDLY MAKER-QUANTITY-1 NO

GAS MODEL IDLY BOX WITH BURNER SET CAPACITY 60NOS IDLY

32)UTBOIL0111-MILK BOILER- QUANTITY-1 NO

LPG MODEL CAPACITY 20 LITRE

33) UTBOIL0112-WATER BOILER- QUANTITY-1 NO

LPG MODEL CAPCAITY 20 LITRE

34) UTCOKR0111-RICE COOKER WITH GEAR TILTING MECHANISM (LPG OPERATION)- QUANTITY- 2 NOS

DOUBLE WALL GLASS WOOL INSULATED SS304 GRADE BODY(MADE S.S STEEL 304 GRADE 18SWG, PROVIDED WITH S.S 304 GRADE 20SWG PERFORATED REMOVABLE TYPE FILTER AND DRAIN VALVE. FITTED WITH HEAVY DUTY HIGH PRESSURE BURNER WITH HOSE AND REGULATOR ATTACHED WITH INDIVIDUAL CONTROLL VALVE. OPERATED BY LPG. LOW FUEL CONSUMPTION APPROXIMATE 2KG GAS FOR 40KG RICE. FITTED WIT WATER INLET AND WATER OUTLET VALVE AND STRAINER AT BOTTOM LEVEL OF THE BOILER ALSO FITTED WITH TOP OPENING LID WITH INSULATED HANDLE. THE ENTIRE BOILER IS MOUNTED ON HEAVY DUTY TUBULAR LEGS. ALSO FITTED WITH A HEAVY DUTY TILTING LEGS. ALSO FITTED WITH A HEAVY DUTY TILTING GEAR TO EXTRACT THE BOILED FOOD. CAPACITY-60 KG

35) GEFANE0118-EXHAUST FAN (ALMONARD BRAND)(SINGLE PHASE HEAVY DUTY ,380MM SWEEP-QUANTITY-4 NOS

36) UTPELR0111- POTATO PEELER SUITABLE FOR 10KG AND BODY MADE WITH S.S 304 GRADE STEEL-QUANTITY-1 NO

37) FMRACK0127-GLASS RACK (FRAME MADE WITH S.S 304 GRADE 1" SQUARE PIPES AND STORAGE OF 100 GLASS-QUANTITY-1 NO.

38 FMTRLY0154- UTILITY TROLLY(FRAME MADE WITH 1 1/2 DIA 16SWG 304 GRADE S.S PIPES, TRAYS ARE MADE BY 16SWG S.S 304 GRADE SHEETS.LEGS ARE FITTED WITH 4 WHEELS FOR MOVEMENT. QUANTITY-2 NOS.(L-600,W-750,H-650MM)

39) FMTRLY0155-PLATFORM TROLLY (FRAME AND CROSS SUPPORT MADE WITH 1 1/2 "X1" RECTANGULAR 304 GRADE S.S 16SWG THICK PIPES. PLATEFORM MADE WITH 12 SWG 304 GRADE S.S SHEET . 4 WHEELS ARE FITTED ON BOTTOM OF PLATEFORM FOR MOVEMENT AND SUITABLE HANDLES /FRAME MADE OF 25MM DIA 304 GRADE S.S PIPE FOR CARRIAGE) (L-90CM, W-60CM).QUANTITY-1 NOS(L-900MM,W-600MM)

ANNEXURE – 2

TECHNICAL BID

The Technical Bid consists of the following

1. Clear specification matching as given in the tender document
2. Product No/catalogue No. (Catalogue in original to be attached)
3. Model No.
4. Technical features
5. Technical Parameters
6. How old is this technology & when is going to be discontinued
7. When is the upgraded/Updated version likely to come
8. Additional features very particulate to the system.
9. If workstation or PC is quoted, its full configuration, brand, model No. etc.
10. Period of warranty as called for in the Tender.
11. AMC Coverage items
 - a. Comprehensive (Spares & Labour)
 - b. Labour alone
12. History of service and maintenance support in the Institute.
13. List of Installations in public sector/private sector with contact person Name & Telephone No.
14. List of essential spares
15. Tender form fee receipt/Demand draft Rs. 525/-(Rs.500 + VAT 5%). Tender fee can be waived based on relevant certificates for the tendered items.
16. Certificate of quality like CE,ISO,FDA etc
(Compliance statement should be submitted)-format below

Sl. No.	Our specification	Yes/No	Your Brand , Model/Cat No. if any

COMMERCIAL BID

1. Item wise cost of components given in the commercial bid
2. Excise duty if any (For INR Purchase)
3. Customs duty if any (for import purchase)
4. Packing, Forwarding, Freight, Insurance etc if applicable
5. Central Sales Tax/VAT if any
6. Delivery period
7. Mode of despatch
8. Mode of payment
9. AMC rate
 - a. Comprehensive coverage items.
 - b. Labour Coverage items.
10. Price of essential spares listed in the technical bid. Price frozen for a period of 3 years after warranty period.
11. Agency commission rate
12. EMD for 5% of the FOB value of the total quoted items (rates multiplied by quantity) value valid upto 180 days by way of Bank Guarantee/Demand draft- in the name of Director, SCTIMST payable at Thiruvanthapuram). The EMD can be waived based on relevant certificates for the tendered items on production of documents such as DGS&D, NSIC Registration Certificate etc for the specific category of item and remain valid for the period required for EMD.
(compliance statement should be submitted)

GUARANTEE BOND FOR EARNEST MONEY DEPOSIT

In consideration of the Director, Sree Chitra Tirunal Institute for Medical Sciences & Technology, Thiruvananthapuram, Kerala (hereinafter called the “Employer”) having agreed to exempt M/s.....(hereinafter called the said “Contractor”) from the demand under the terms and conditions of Tender No.....dated.....issued by the Employer to the said Contractor for Rs.....(Rupees.....only) of Earnest Money Deposit for the due fulfillment by the said Contractor of the terms and conditions contained in the said tender on production of a bank guarantee for Rs....., we, Bank of.....do hereby undertake to indemnify and keep indemnified the Employer to the extent of Rs.....against any loss or damage caused to or suffered by the Employer by reason of any breach by the said Contractor of any of the terms and conditions contained in the said tender.

We, Bank offurther agree that the guarantee herein contained shall remain in full force and effect during the period that would be taken for the finalisation of the said tender and that it shall continue to be enforceable till the tender is finally decided and order placed on the successful tenderer or tillwhichever is earlier.

We, Bank of.....lastly undertake not to revoke the guarantee during its currency except with the previous consent of the Employer in writing.

Notwithstanding anything stated above, our liability under this guarantee is restricted to Rs.....Our guarantee shall remain in force until unless a demand in writing to enforce a claim under this guarantee is filed against us before that date, all your rights under the said guarantee shall be released and discharged from all liability there under.

KITCHEN EQUIPMENT LAY OUT AT NEW CANTEEN GF LEVEL

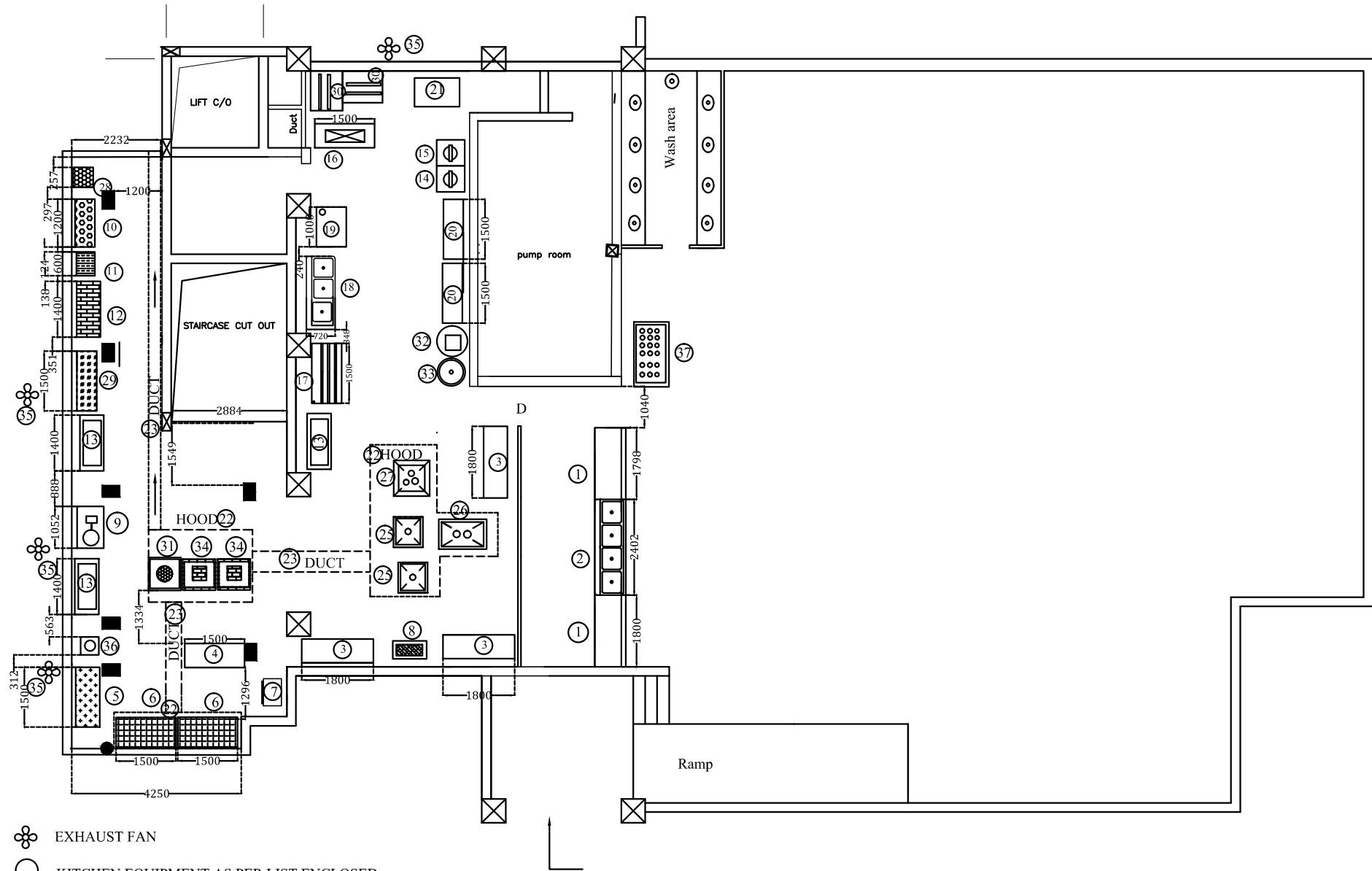

- EXHAUST FAN
- KITCHEN EQUIPMENT AS PER LIST ENCLOSED

KITCHEN EQUIPMENT(EXHAUST HOOD & DUCT LAY OUT AT NEW CANTEEN GF LEVEL

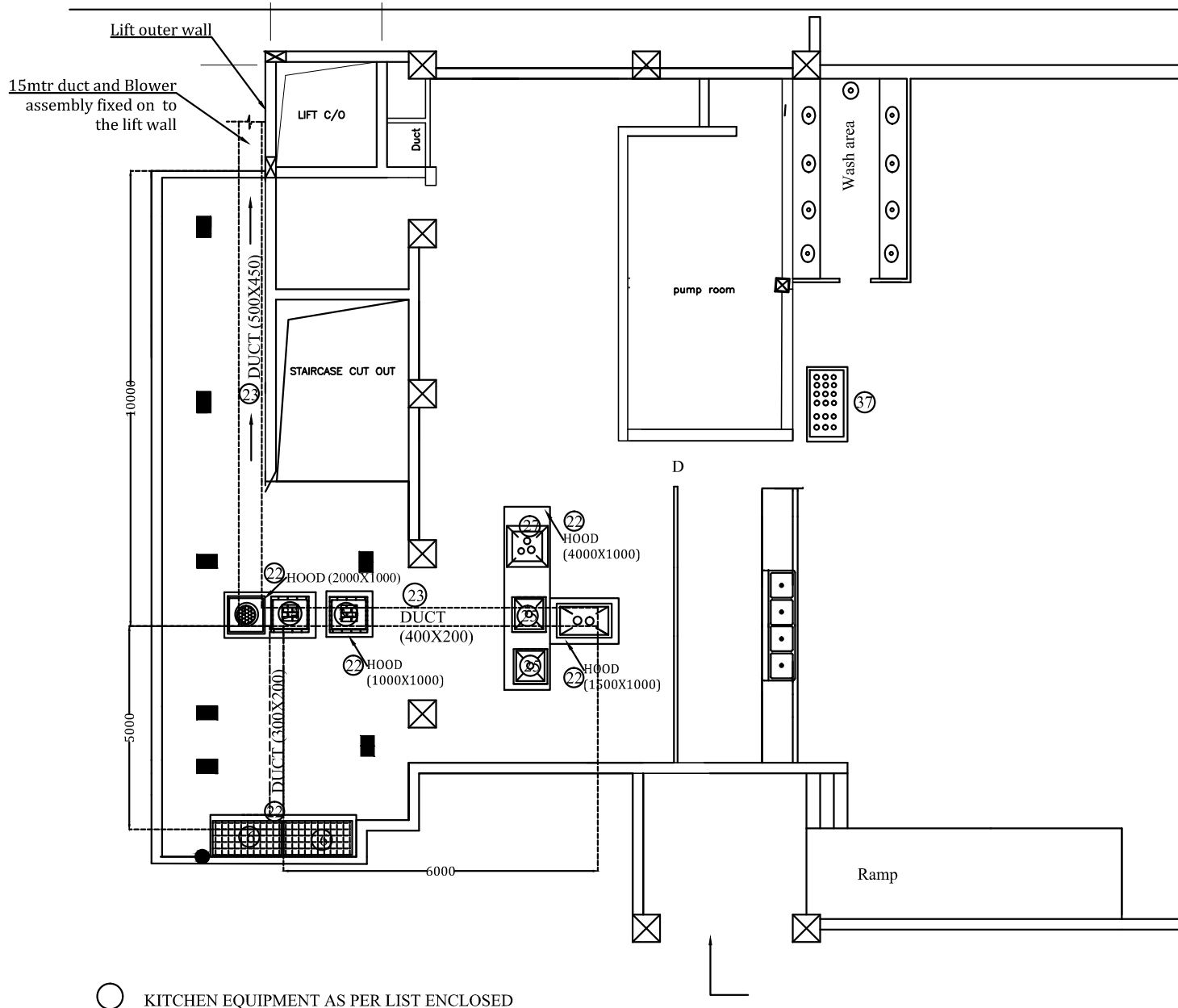

KITCHEN EQUIPMENT LAY OUT AT NEW CANTEEN BASEMENT LEVEL

